

Residence in Agios Athanasios



19 B & C Kosti Palama, Mesa Geitonia, Limassol 4001 Cyprus
Tel: +35725751975 | Fax: +35725751976 |
Email: papasest@logosnet.com.cy
Website: www.npapasgroup.com

Property development of a modern residence consisting of four floors. There is one basement with an indoor gym, kitchen, two living rooms, four bedrooms, four bathrooms and a kitchenette on the top floor. The new residence will be situated in the fantastic area of Agios Athanasios, within a few minutes access to the highway to cities like Paphos, Larnaka and Nicosia. Agios Athanasios, a suburb of Limassol combines both nature views and a quick hop to the center of Limassol!



19 B & C Kosti Palama, Mesa Geitonia, Limassol 4001 Cyprus
Tel: +35725751975 | Fax: +35725751976 |
Email: papasest@logosnet.com.cy
Website: www.npapasgroup.com



PRICE UPON REQUEST

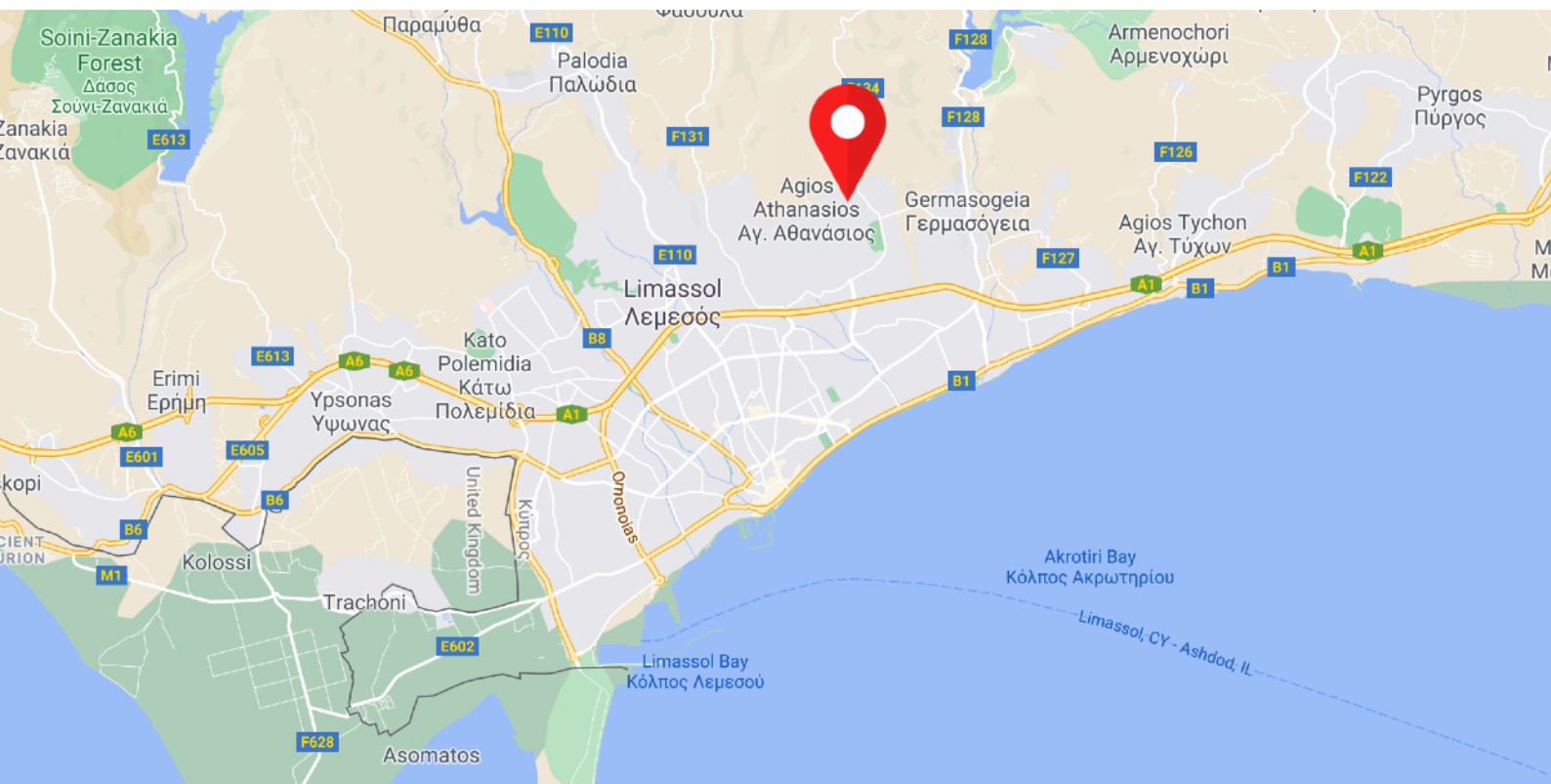

19 B & C Kosti Palama, Mesa Geitonia, Limassol 4001 Cyprus
Tel: +35725751975 | Fax: +35725751976 |
Email: papasest@logosnet.com.cy
Website: www.npapasgroup.com

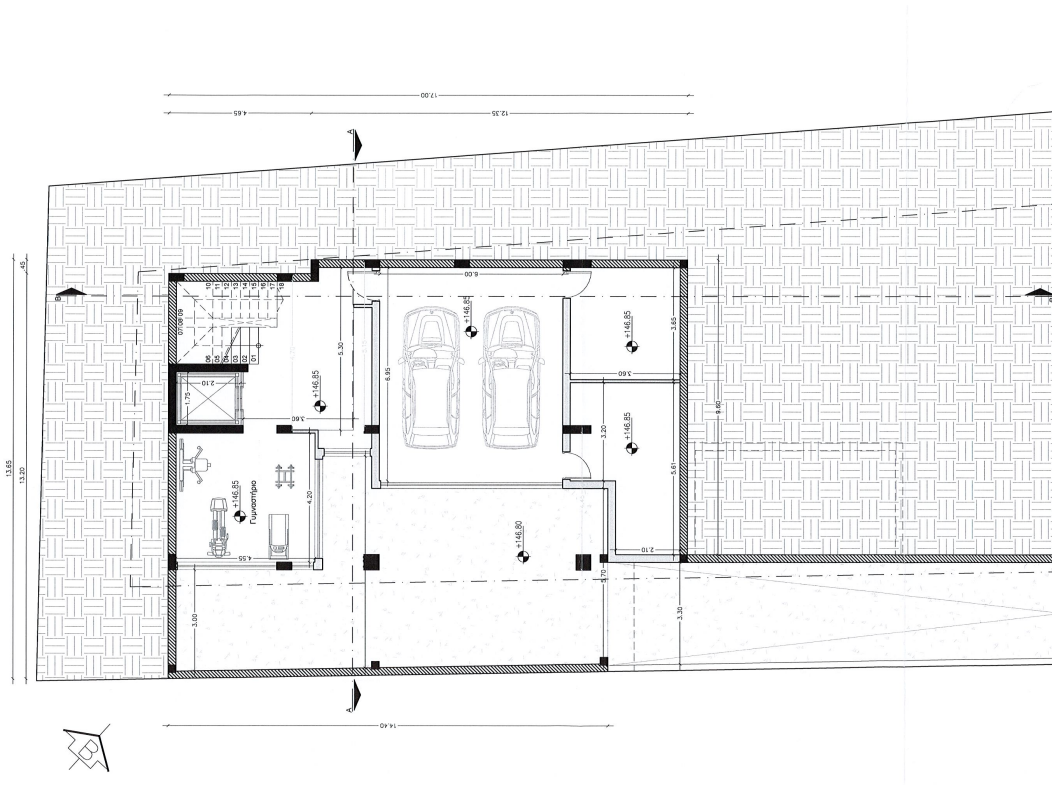

Basement 142m²

Ground Floor 132m² - Veranda Covered 32,6m² - Veranda Uncovered 128m²

